

Master of Public Health

2010

VICTORIAN CONSORTIUM
FOR PUBLIC HEALTH

STUDY WITH FOUR OF VICTORIA'S
LEADING UNIVERSITIES

WWW.PUBLICHEALTH.VIC.EDU.AU



2010 Master of Public Health

VICTORIAN CONSORTIUM FOR PUBLIC HEALTH

Contents

1	Introduction	Page 4
2	Course aims	Page 5
3	Course overview	Page 5
4	Master of Public Health Part I	Page 6
5	Master of Public Health Part II	Page 11
5.1	Deakin University	Page 12
5.2	La Trobe University	Page 15
5.3	Monash University	Page 20
5.4	The University of Melbourne	Page 24
6	International students	Page 31
7	Contact details	Page 32
8	Notes	Page 33

1» Introduction

Master of Public Health at the Victorian Consortium for Public Health (VCPH)

The VCPH Master of Public Health course is unique, bringing together key expertise from Victoria's four leading universities. Students are exposed to a breadth of disciplines delivered by academic staff with extensive experience and depth of knowledge. The universities work together in a collegial and coordinated approach to course delivery.

We invite you to join this dynamic program where you will not only gain essential skills with your qualification, but also make valuable personal and professional contacts through the students and staff involved in the course.

The course provides students with a broad-based understanding of public health, plus advanced specialist skills in Australian and international public health. More specifically, within the public health context, this course aims to provide graduates with the knowledge and skills necessary to develop, analyse and implement policy, plan and evaluate health services and programs, and understand how research and project work are conducted.

All students study Part I Consortium units together at a common location and then progress to specialise in a chosen field at their home university.

Course flexibility allows students to structure their course in a variety of ways. Some choose a standard pathway, whilst others tailor a study plan to suit their career goals and professional needs. Beyond the initial common subjects, the Consortium encourages students to draw from the wide range of subjects available in public health specialisations across the four universities.

Our students come from diverse backgrounds, reflective of the multi-disciplinary nature of public health. These include medical and dental practitioners, nurses, hospital staff (both clinical and administrative), allied health staff, medical researchers, para-medical practitioners, biologists, scientists and policy makers.

Students undertake postgraduate study for professional development, and specifically choose to undertake the Master of Public Health because it is a standard qualification recognised worldwide. Through the skills developed during the course, our graduates often go on to make career changes and many become leaders in their field. Graduates are employed in a wide range of settings worldwide, as diverse as international health bodies, clinical research environments, State and Commonwealth health authorities, NGOs and aid organisations.

About the Consortium

The Victorian Consortium for Public Health was established in 1993 and comprises four partners:

- The School of Health and Social Development at Deakin University
- The School of Public Health at La Trobe University
- The Department of Epidemiology and Preventive Medicine at Monash University
- The School of Population Health at The University of Melbourne

The Consortium aims to support the enhancement of health in Australia and other countries through the development and implementation of high quality education, research, training and consultancy activities in public health.

The Australian Government Department of Health and Ageing has awarded the Consortium partners a grant under the Public Health Education and Research Program (PHERP) to aid in the development and ongoing teaching of this program.

2» Course Aims

The Master of Public Health program aims to develop public health capacity through public health education by:

- providing a multi-disciplinary Master of Public Health degree by public health specialisation coursework and minor thesis or project
- ensuring that graduates have a broad-based understanding of the determinants of health in populations
- contributing to the development and vigour of the greater public health community
- equipping students with the knowledge and skills necessary to maintain and improve existing health promoting environments
- training, retraining and upskilling health professionals to meet public health workforce needs
- carrying out research to identify public health priorities and generating initiatives for policy and action
- developing strategies to equip graduates to ensure equity in the health system and interventions to promote the health of disadvantaged groups
- developing understanding of health issues and contributing to the improvement of public health research capability worldwide
- instilling in students the rigorous standards required for excellence in research, and
- creating an environment which will attract and retain quality teaching and research staff.

3» Course Overview

The Master of Public Health at all four Consortium Universities consists of Part I and Part II.

The core MPH units are taught to the students of the four universities together at a common location. Each contributing University teaches two units in the common Part I.

Students take these units as part of their first full-time year equivalent and then progress to study a specialised stream (Part II) at their home university.

Entry requirements for the different universities are described in detail in the chapters for each of the universities. These differences are reflected in the different structures of the MPH courses offered by the different Universities.

Deakin University	La Trobe University	Monash University	The University of Melbourne
Part I (5 – 6 units)	Part I (4 – 8 Units)	Part I 2 core units	Part I 4 – 8 Part I units (depending on entry pathway) including the 2 core units Introduction to Biostatistics and Epidemiology & Demography
Part II (6 – 7 units) Option A includes a 2 unit research project Option B includes a 4 unit research project	Part II (4 – 8 units) Research Mode (3 unit thesis) Practice Mode (2 unit action learning project)	Part II: 10 units = 1 core unit plus 9 units / 7 units + minor project / 5 units + major project (research stream)	Part II 6 – 10 units (depending on entry pathway) and a Year long research project

4» Master of Public Health Part I

The four Consortium member universities teach eight core units jointly at the Parkville campus of The University of Melbourne. The number and type of Part I Consortium units a student is required to take varies, depending on their home university course structure.

Deakin University	La Trobe University	Monash University	The University of Melbourne
Epidemiology and Demography Introduction to Biostatistics			
Principles and Practice of Public Health Health Promotion	Public Health Policy Social & Cultural Perspectives in Public Health		Plus 2 elective Part I subjects (or up to 6 depending on entry pathway)
Plus one elective Part I subject	Students may take the remaining four subjects as electives		

VENUE FOR PART I CONSORTIUM UNITS

Part I lectures and tutorials are held at the University of Melbourne, Parkville Campus

The campus is easily accessible by public transport. See www.metlinkmelbourne.com.au for transport details.

Most lectures will be held at the School of Population Health, Public Policy Theatre or Wright Theatre as shown in the map below.

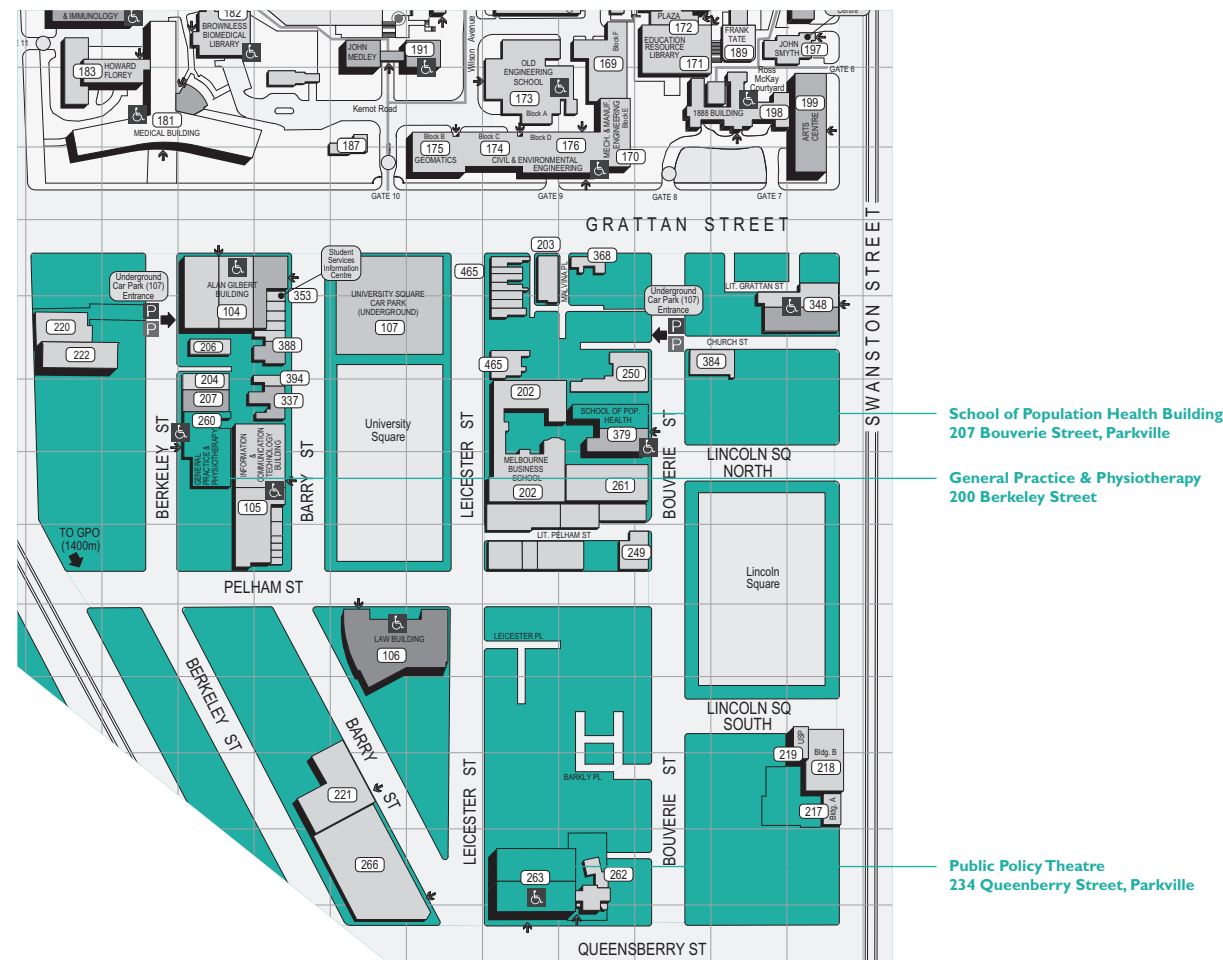

PART I CONSORTIUM UNIT TIMETABLE

Classes are held at the University of Melbourne, Parkville Campus

Semester dates

Semester 1: 1 March – 30 May, 2010

Semester 2: 26 July – 31 October

Day	Time	Semester 1	Time	Semester 2
Wednesday	1:15 – 2:15 pm (lecture) 3:15 – 5:45 pm (during this period a 1 x hr tute)	Epidemiology and Demography	2:15 – 4:15 pm	Social and Cultural Perspectives in Public Health
Wednesday	2:15 – 3:15 pm (lecture) 3:15 – 5:45 pm (during this period a 1 x hr tute)	Introduction to Biostatistics	5:15 – 7:15 pm	Health Promotion
Thursday	2:15 – 4:15 pm	Public Health Policy	2:15 – 4:15 pm	Environmental Influences on Health
Thursday	5:15 – 7:15 pm	Principles and Practices of Public Health	5:15 – 7:15 pm	Health Economics and Program Evaluation

UNIT CODES

Unit	Deakin	La Trobe	Monash	Melbourne
Epidemiology and Demography	HSH714	PHE5EPI	MPH1030	505102
Introduction to Biostatistics	HSH716	PHE5IST	MPH1031	505101
Health Promotion	HSH703	PHE5HPR	MPH1016	505110
Environmental Influences on Health	HSH713	PHE5ENV	MPH1003	505112
Public Health Policy	HSH711	PHE5POL	MPH2031	505113
Health Economics & Program Evaluation	HSH708	PHE5HEV	MPH2035	505100
Principles & Practice of Public Health	HSH701	PHE5PPP	MPH2025	505111
Social & Cultural Perspectives in Public Health	HSH710	PHE5SCP	MPH2034	505109

PART I CONSORTIUM UNIT DESCRIPTIONS

Epidemiology and Demography

Unit Coordinator: Professor Flavia Cicuttini
Monash University

The aim of this unit is to provide students with basic quantitative skills necessary for the practice of general public health and to enable students to critically evaluate the published epidemiological literature.

The unit provides an introduction to descriptive and analytical epidemiology, case-control studies, cohort studies, clinical trials, risk and causation, bias, confounding, health program evaluation and measurement theory.

At the completion of this unit, students should be able to:

- explain the methods and applications of descriptive and analytical epidemiology
- explain the strengths and weaknesses of different epidemiological study designs
- solve problems relating to the principal epidemiological concepts
- critically appraise epidemiological papers, and
- explain the uses of epidemiology in the practice of public health.
- calculate and explain the interpretation of confidence intervals.

4» Master of Public Health Part I

PART I CONSORTIUM UNIT DESCRIPTIONS CONT'D

Introduction to Biostatistics

Unit Coordinator: Dr Julie Simpson
The University of Melbourne

This unit aims to introduce students to basic statistical concepts and methods. At the completion of the unit, students should be able to:

- perform simple statistical analyses of small data sets by hand
- identify the appropriate technique for data analysis

- calculate and explain the interpretation of confidence intervals.
- obtain p-values from tables
- distinguish between clinical and statistical significance
- understand the concept of a Type I and Type II error and identify where these may have occurred

Health Promotion

Unit Coordinator: Dr Shane McIver
Deakin University

This unit aims to develop a knowledge and comprehension of health promotion theoretical frameworks, give students experience in developing health promotion strategies and equip students with an understanding of health promotion concepts and approaches as they relate to contemporary health issues in Australia and in other countries.

The unit aims to enable students to:

- appreciate the key developments in Australia and internationally that have contributed to our current understanding of health and health promotion
- examine the range of theoretical and practical intervention frameworks available in health promotion
- become familiar with the information and skills required for the development of evidence-based health promotion programs
- describe and form opinions on debates, dilemmas and difficulties in health promotion.

Health Economics and Program Evaluation

Unit Coordinators:
Dr Arthur Hsueh – (Health Economics)
Ms Rosemary McKenzie – (Program Evaluation)
The University of Melbourne

This unit provides an introduction to health economics and to the principles, methods and research skills required for the economic evaluation and/or program evaluation of health care programs. As such, students will have the opportunity to develop an appreciation of the contribution health economics and program evaluation make to the practice of public health.

There are two principal areas of learning within this unit:

- health economics/economic evaluation – which introduces students to the role and usefulness of economic analysis through provocative lectures on selected topics of policy interest; and
- health program evaluation – which provides a basic introduction to program evaluation principles and design applicable to public health programs.

Public Health Policy

Unit Coordinator: Professor Vivian Lin
La Trobe University

The purpose of this unit is to equip students with the knowledge and skills needed to participate competently in the development, implementation and analysis of health policy at a level appropriate to a generalist public health practitioner.

On completing this unit students should be able to:

- describe the major state national and international institutions and arrangements through which health policy is made
- describe the contemporary policy environment within which health policy making takes place
- demonstrate familiarity with the arguments and the politics associated with major contemporary health policy issues
- demonstrate competence in policy analysis, policy development and policy advocacy in relation to important public health issues.

Social and Cultural Perspectives in Public Health

Unit Coordinator: Dr Bruce Rumbold
La Trobe University

The social and behavioural sciences are significant resources for public health theory and provide important tools for grounding public health practice. This unit will explore the multidisciplinary partnerships between public health and the social science disciplines, including sociology and anthropology, with particular attention to the ways in which cultural beliefs and practices shape population health. The unit will begin with a historical overview, drawing on the work of key social scientists who have laid the foundations for contemporary

sociological and anthropological theory, research and practice of importance to public health and social epidemiology. The second part of this unit will focus on the contemporary case studies of the contribution of social and behavioural science to public health theory and practice. The third and final part of this unit will critically examine how key public health challenges in Australia and more globally can be understood using the social and political sciences. Thus this unit will provide students with a solid grounding in understanding the different ways in which the social sciences contribute to public health theory and practice.

Environmental Influences on Health

Unit Coordinators: Professor Malcolm Sim
Monash University

This unit provides examples of how chemical, physical and biological factors in the environment may influence health, and to draw from these examples the principles of assessment, communication and control of hazard and risk.

At the end of the unit, students should be able to:

- nominate the important chemical, physical and biological hazards in the environment and risks to health from environmental factors in Australia

- demonstrate fluency with the terminology used to describe chemical, physical and microbiological hazards encountered in the community
- critically appraise published epidemiological articles related to environmental health risks
- relate methods to identify common hazards in environmental media such as water, air and food, and methods to assess the degree of risk from these hazards
- nominate common interventions used to control environmental risks and prevent injury, including standard setting, and the key personal, social and economic factors that inhibit controls or lessen their impact, and
- effectively and sensitively communicate information and principles about environmental hazards and risks.

Principles and Practice of Public Health

Unit Coordinator: Associate Professor Bernie Marshall
Deakin University

The overall aim of this unit is to provide students with an integrated overview of the ways in which different theories and disciplinary perspectives have informed public health principles and practices in Western societies, both in the past and in the present.

disasters and disease have shaped contemporary perspectives and practices of public health. Within this wider context, current organisational structures for the development of public health policy and the delivery of services and programs at the local, state and national level will be described.

The unit examines the ways in which theories of knowledge, social movements, political and social organisation and natural and human

The unit provides the foundations for a contextual understanding of the specific methods of public health research, policy development and program planning and implementation.

CROSS INSTITUTIONAL STUDY

Beyond initial common Part I units, the Consortium encourages students to draw from the wide range of units available in public health specialisations across the four universities (see Part II subject listing).

Students wishing to take cross institutional studies need to gain approval from their home university and the partner university hosting the unit. For further details contact the MPH administrator at the university at which you intend to apply (see Contacts, Section 7).

5» Master of Public Health Part II

The VCPH universities tailor their units into a broad range of streams which reflect their expertise in public health practice, teaching and research. Because of these important differences each university has specific requirements for completion of Part II. These are set out in this section of the handbook.

In consultation with their academic coordinator students are able to tailor their course to suit their individual educational needs. To achieve the best mix many students take subjects from other universities to increase the opportunities an MPH course offers. Limitations apply to the number of cross institutional units a student can enrol in.

All VCPH universities allow cross-institutional enrolments; however because of different funding arrangements at the four universities

students who have a HECS CSP funded place at their home university will not necessarily be able to access a similarly funded place at a different host institution. Cross-institutional enrolments may therefore only be accessible on a full-fees basis.

Contact your home university **as well** as the host university's academic and administrative coordinators for further details and clarification of these matters.

5.1» Deakin University

OVERVIEW

Course requirement: 12 units

Length: Full time (18 months)/part time (three years)

Unit delivery: On/off campus study with enhanced on-line learning

For most Deakin students, the MPH will comprise five units from the Part I Consortium units, plus seven elective Part II units.

For the Part II units students have two options:

- HSH725 Research for Health Practice, three units of specialisation, one elective unit from any approved masters offering, including from within the MPH programs of the Victorian Consortium partner universities, plus a two-unit equivalent minor research project, or
- HSH725 Research for Health Practice, two units of specialisation and a four-unit equivalent research project (12,000 – 15,000 words).

If students wish to specialise they must take four units from the same area, otherwise units may be chosen from any area, subject to meeting pre or corequisites.

At Deakin University students may specialise in:

- Health Promotion
- Public Health Nutrition
- Environments for Health
- Equity and Social Determinants of Health
- Public Health Research
- General Stream (by negotiation)

Website: <http://www.deakin.edu.au/future-students/>

Email: hmnbs-support@deakin.edu.au

COURSE DETAILS

The Master of Public Health, along with a PhD and professional doctorate, are offered through the School of Health and Social Development.

Deakin University is a diverse and dynamic institution offering courses both on and off campus, with an emphasis on innovative teaching and learning strategies that utilise current technologies and flexible modes of study. As one of the larger universities in Australia, Deakin is committed to ensuring that students are provided with the highest quality education programs.

As well as the MPH, the Faculty of Health, Medicine, Nursing and Behavioural Sciences offers graduate certificates, graduate diplomas, masters and doctoral degrees in nutrition, dietetics, exercise science and sports nutrition and health promotion.

SPECIALIST STREAMS

Health Promotion

Health Promotion is the action arm of public health and this stream provides students with the theory and practical skills for developing, implementing and evaluating strategies, programs and policies to promote health in populations.

This specialty is designed for people working in a variety of settings including state and local government, health care and the community. Students are able to select units suitable for their individual career development. The unit choices provide opportunities for students to acquire a comprehensive range of technical skills (such as strategic planning, multiphase program management and evaluation), and to gain valuable insights into the interplay of factors that define the complex social, economic and political environments that promote health.

The following unit areas are offered in the Health Promotion specialty:

- Health Education and Communication Strategies
- Health Promotion Program Planning and Evaluation
- Contemporary Health Policies and Issues
- Health and Social Impact Assessment
- Qualitative Methods for Public Health Research
- Health Equity and Human Rights

Contact: Dr Jan Moore

Telephone: (03) 9244 3748

Email: jan.moore@deakin.edu.au

Public Health Nutrition

The Public Health Nutrition specialty is one of the few custom designed sequences in public health nutrition in Australia and will be expanded to include physical activity.

This specialty can be taken by those with or without a specialist nutrition background. The sequence builds on the most recent insights of nutritional epidemiology and community nutrition to take students through the theoretical and practical underpinnings of the skills and knowledge needed to practice public health nutrition in policy, health promotion or primary care settings.

Some of the units offered in the Public Health Nutrition specialty are:

- Principles of Nutrition
- Diet and Disease
- Food and Nutrition Policies
- Population Nutrition

Contact: Wendy Hunter

Telephone: (03) 9244 3788

Email: wendy.hunter@deakin.edu.au

Equity and Social Determinants of Health

The study of equity and social determinants of health combines the methods and theory of epidemiology and public health social science.

This approach is aimed at understanding the relationships between the social environment and health outcomes. A key focus is on inequalities in health and on health outcomes within culturally diverse populations like Australia. Emphasis is on the methods and theory for researching and understanding the ways social processes and factors impact on the health of populations. Methodological units include the application of qualitative methods to public health research and the methods and theory of social and behavioural epidemiology. Topic specific units focus on gender, ethnicity, equity and sustainability in public health and the application of newly emerging concepts such as social capital and health gains. This stream is complementary to the international health stream at Monash University and is especially relevant to those interested in increasing their skills and

knowledge in medical anthropology and social epidemiology research in public health.

The following unit will be offered in the Social Determinates of Health specialty:

- Social Epidemiology
- Gender, Culture and Population Health
- Health and Social Impact Assessment
- Research for Health Practice (1cp)
- Qualitative Methods for Public Health Research
- Health Equity and Human Rights

Contact: Dr Julia Shelley

Telephone: (03) 9244 6293

Email: julia.shelley@deakin.edu.au

Environments for Health

This MPH elective stream focuses on the individual, organisational, community, social, political, economic, and other environmental factors affecting health and well-being. To achieve municipal level change, this stream examines mechanisms for public health approaches to improve population health through personal, social and environmental action, rather than individual action alone.

By placing explicit emphasis on the social, economic, natural and built environments at national, international and global levels, this approach makes public health a central focus for all levels and departments of government, and focuses on the importance of strategic planning, advocacy, coordination and facilitation of community participation.

including the community, in planning for health and well-being. Taking a systems approach means ensuring that all relevant inputs into the planning process are taken into account.

The following units will be offered in the Environments for Health specialty:

- Local Action for Healthy Cities and Communities (1cp)
- International Perspectives on Health Policy and Planning (1cp)
- Health and Social Impact Assessment (1cp)
- Community Consultation and Participation (1cp)
- People, Health and Planning (1cp)

Contact: Mardie Townsend

Telephone: (03) 9251 7278

Email: mardie.townsend@deakin.edu.au

Public Health Research

The Public Health Research specialty offers students the opportunity to undertake a major research project (4 credit points) as part of their MPH Studies.

This involves a literature review and development of a research question, the design of the research methodology, development of the ethics application, collection and analysis of data, and the preparation of a thesis and an oral presentation. Students will be linked with one of the research teams at Deakin University or with one of our research partners in the professional community.

The following units will be offered in the Public Health Research specialty:

- Social Epidemiology (1cp)
- Health and Social Impact Assessment (1cp)
- Qualitative Methods for Public Health Research (1cp)
- Research for Health Practice (1cp)
- Major Project (4cp)

Contact: Dr Fiona Andrews

Telephone: (03) 9251 7053

Email: fiona.andrews@deakin.edu.au

PART II UNITS

Unit Code	Unit Name	Semester	Mode
HSH 702	Contemporary Health Policies	1	O/D
HSH 704	Health Education and Communication Strategies	2	O/D
HSH 705	Health Promotion Program Planning and Evaluation	2	I/D
HSH 706	Social Epidemiology	2	O
HSH 709	Health and Social Impact Assessment	1/2	I
HSH 715	Qualitative Methods for Public Health Research	1	O
HSH 717	Health Economics I	1	O
HSH 719	Economic Evaluation I	2	O
HSH 721	Minor Project (MPH)	1/2/Y	O/D
HSH 722	Major Project (MPH)	1/2/Y	O/D
HSH 724	Local Action for Healthy Cities and Communities	2	O
HSH 725	Research for Health Practice	1/2	O/D
HSH 728	Health Equity and Human Rights	1	O/D
HSH 736	Community Consultation and Participation	1	O
HSH 740	People, Health and Planning	2	O
HSN 701	Principles of Nutrition	1	D
HSN 702	Human Nutrition	2	D
HSN 703	Diet and Disease	1	D
HSN 704	Social Nutrition	2	D
HSN 705	Population Food and Health Issues	1	D
HSN 706	Food and Nutrition Evidence, Politics and Policy	2	D
HSN 708	Nutrition, Promotion and Communication	2	D
HSN 713	Food, Nutrition and Behaviour	1	D
HSN 717	Food and the Environment	1	D
HSN 734	Obesity Prevention	2	D
HSN 738	International Nutrition	2	D

For further details regarding units from Deakin University refer to the course details at: <http://www.deakin.edu.au/hbs/hsd/>

D Distance Education I Intensive
O On campus

ENTRY REQUIREMENTS AND APPLICATIONS

Local Student Entry Requirements

Application requirements vary between Consortium institutions.

For further details and an application form please contact your chosen university using the details listed on Section 7.

Applicants normally have an undergraduate degree and field experience in public health or a related area. Selection is based on additional criteria including a written statement outlining reasons for undertaking the course and a demonstrated involvement in professional activities related to public health.

International student requirements

Application requirements for international students vary between the four universities in the Consortium. As well as fulfilling the general requirements above, students need to meet the specific entry requirements of the university they apply to. For full details and an application form please contact your chosen university using the details listed.

The International Office

Deakin University
Building 1a, Entrance 3, 70 Elgar Rd,
Burwood, Victoria 3125 Australia
Telephone: 61 3 9244 5095 and 61 3 9627 4877
Fax: 61 3 9244 5094
Web: www.deakin.edu.au/international

5.2» La Trobe University

OVERVIEW

Course requirement: 12 – 16 units. Students who have completed a minimum of two years full time equivalent work experience in a health related field and have a health related degree or equivalent can be granted advanced standing in up to 4 units.

Length: Full time (1.5 to 2 years)/part time (3 to 4 years)

Unit delivery: on campus / distance education / on-line / blocks

Students must complete four core Part I Consortium units at Parkville (Epidemiology and Demography, Introduction to Biostatistics, Public Health Policy and Social and Cultural Perspectives in Public Health). We recommend that an additional one or two of the remaining four Part I core units are also completed, depending on the past experience of the student and consultation with academic coordinator.

Part II includes a core unit Evidence Based Public Health. Part II can be taken in either research or practice mode as outlined in the following table:

Part II Program

Research Mode	Practice Mode
Thesis Three unit equivalent At least 2 research methods units plus 3 – 5 elective unit from specialist streams	Action Learning Project Two unit equivalent 5 – 9 elective units from specialist streams, at least 3 from a nominated speciality stream

The La Trobe specialist streams are:

- Health Policy
- Health Services Management
- Health Promotion
- Workplace Health and Rehabilitation
- International Health Policy
- General Stream
- Health and Social Care

A number of units are offered within each specialist stream. Students may choose units from any part of the programme to complete Part II and are not restricted to the units within any particular stream.

Students who complete eight units (including Part I units Epidemiology & Demography, Introduction to Biostatistics, Public Health Policy, Social & Cultural Perspectives in Public Health and Principles and Practices of Public Health), as well as the Part II unit PHE5EBP but do not wish to proceed to a specialised stream are eligible to discontinue and take out the Postgraduate Diploma in Public Health.

Website: <http://www.latrobe.edu.au/publichealth/MPH/index.htm>
Email: phe.postgrad@latrobe.edu.au

COURSE DETAILS

The School of Public Health at La Trobe University is one of the largest in Australia and is known internationally for its strengths in the practise, teaching and research of health policy, health promotion and health social sciences, health services management and gerontology. The School of Public Health and the Faculty of Health Sciences have a strong practice focus with a range of research and consultancy involvements in policy, evaluation and teaching at the state, national and international levels.

Many members of Staff of the School have extensive practical as well as academic experience in health service management and in the research centres associated with the School have international standing in maternal and child health epidemiology, sexual health, palliative care, family therapy and primary health care.

As well as the MPH, the School of Public Health offers graduate certificates, postgraduate diplomas, masters and doctoral degrees

in health policy, health services management, health promotion, gerontology, family therapy, counselling, palliative care and rehabilitation. The teaching of part II units usually takes place at the city campus.

La Trobe has two specialised modes of study – one with a focus on public health research and the other with a focus on public health practice.

RESEARCH MODE

This option is aimed at students who want to develop their research skills. The disciplines of recognizing a researchable problem, devising a research strategy, collecting and analysing data and writing and reporting the results are valuable competencies in all areas of public health. Training in research skills and the experience of writing a minor thesis are essential for students who want to proceed to a PhD or DPH.

This option involves:

- at least two research methods units
- a three unit equivalent minor thesis; and
- 2 – 6 electives relevant to the research topic.

The core research methods units on offer are:

- Advanced Research Skills
- Quantitative Research Methods

- Qualitative Methods in Health Research

The minor thesis is equivalent to three coursework units. The thesis is required to be 12,500 words. In selecting their elective units, students are encouraged to select units that will support their thesis research. Students are advised to consider Sociology of Health and Illness and Advanced Research Skills.

PRACTICE MODE

This option involves a two-unit-equivalent 'learning in practice' unit; at least three units from within the nominated specialty stream (see the specialty stream units listed below); and 2 – 5 further electives.

Action Learning Project

Students gain practical experience applying analytical and problem-solving strategies to actual health service organisations and health programs, using an action learning framework.

Through practical workshops and smaller meetings the action learning teams are established and the issues and projects to be examined and developed by the team are identified in consultation

with representatives from the health industry. Teams then develop and implement problem-solving strategies. Invited industry representatives attend the final workshop which showcases the work of the teams.

SPECIALIST STREAMS

There are six specialty streams within the Practice mode which are detailed below. Students may negotiate a general stream.

Health Policy

The Health Policy stream provides a program of study that will help students understand policy processes, approaches to developing and evaluating policy, and to explore policy in particular areas of health.

This stream is relevant to people working in government at Commonwealth, State or local levels, or in professional or non-government organisations; people for whom policy practice is part of their business.

Students taking this stream are required to take at least three units from among:

- Health Policy Analysis
- Comparative and Historical Study of Health Systems (online)
- Program Development and Evaluation
- Australian Healthcare System (online)
- Public Health Law (online)

- Evidence Based Public Health
- International Perspectives in Health Economics
- International Health Policy

Coordinator: Professor Vivian Lin
Telephone: (03) 9479 1717
Email: v.lin@latrobe.edu.au

Health Services Management

The Management stream has a focus which is practical and applied. Students develop the skills needed to manage and coordinate health programs and services. The stream supports student learning in the design, implementation and evaluation of management systems in a practical setting.

The course also aims to meet the needs of public health practitioners who have assumed or are likely to assume responsibility for coordination or management of programs and services. The graduates of this stream will have improved their health management knowledge and skills and understanding of the theory and practice in a structured, collective and collaborative educational process.

Students taking this stream are required to take at least three units from among:

- Health Service Resource Management
- Health Economics and Finance
- Health Resource Management in Health Services
- Health Care Quality
- Program Development and Evaluation
- Australian Healthcare System (online)

- Policy, Planning and Administration in Aged Care
- Healthy Organisations
- Health Management Strategy and Operations

Coordinator: Professor Sandra Leggat
Telephone: (03) 9479 1749
Email: s.leggat@latrobe.edu.au

Health Promotion

The Health Promotion stream is designed for health professionals wishing to develop skills and understanding of health promotion in the health system and local government settings. The emphasis is on developing new skills and knowledge extending beyond studies undertaken in the Part I program.

Students taking this stream are required to take at least three units from among:

- Introduction to Health Promotion
- Promoting Health Through Groups
- Program Development and Evaluation
- Public Health Promotion
- Healthy Organisations

- Health Promoting Palliative Care
- Foundation Studies in Gerontology
- Qualitative Methods in Health Research
- Public Health Approaches to Death, Dying and Grief
- Short Course in Reproductive and Perinatal Epidemiology
- Sociology of Health and Illness
- Introduction to Health Promotion
- Public Health Promotion
- Social Food and Nutrition

Coordinator: Associate Professor Rae Walker
Telephone: (03) 9479 5875
Email: r.walker@latrobe.edu.au

Workplace Health and Rehabilitation

The Workplace Health and Rehabilitation stream is designed for practitioners wishing to develop their understanding of the field of occupational health and safety and acquire some of the skills needed for advanced practice in this area.

Students taking this stream are required to take at least three units from among:

- Occupational Health and Safety Principles and Legislation
- Ergonomics in OHS
- Screening and Monitoring in OHS
- Program Development and Evaluation
- Vocational Rehabilitation

- Employment and Disability
- Service Coordination And Case Management
- The Service User Perspective in Health Care

Coordinator: Associate Professor Greg Murphy
Telephone: (03) 9479 1745
Email: g.murphy@latrobe.edu.au

Students may also take up to two units from other universities and are invited to explore the occupational and environmental health units offered through Monash which focus on the interrelationship between health and chemical, physical and biological hazards present in both the workplace and the general environment.

International Health Policy

The International Health Policy Stream is designed for practitioners wishing to develop practical skills, knowledge and understanding in the field of international health policy.

Students taking this stream are required to take at least three units from among:

- International Perspectives in Health Economics
- International Health Policy
- Social Food and Nutrition
- Australia's International Health Relations
- Health Policy Analysis
- Evidence Based Public Health
- Australian Health Care System (online)

- Comparative and Historical Study of Health Systems (online)
- Security Policy in a Borderless World
- Globalisation and Governance
- Rural Health

Coordinator: Dr Priscilla Robinson
Telephone: (03) 9479 5595
Email: priscilla.robinson@latrobe.edu.au

Some IHP units are offered through the School of Political Science. Students may also take up to two units from other universities and are invited to explore the international health units offered through Monash University and The University of Melbourne which focus on a number of clinical areas (such as communicable diseases, HIV AIDS, refugee health programs and primary health care) in international settings.

Health and Social Care

The Healthy Ageing stream is designed for practitioners wishing to develop their understanding their understanding of ageing and older people and acquire practice and policy skills in promoting health and wellbeing in older people.

Students taking this stream are required to take at least three units from among:

- Foundation Studies in Gerontology
- Health Ageing

- Policy, Planning and Administration in Aged Care
- Sociology of Health and Illness
- Public Health Approaches to Death, Dying and Grief
- Health Development Through Groups
- Program Development and Evaluation

Coordinator: Associate Professor Peter Foreman
Telephone: (03) 9479 1721
Email: p.foreman@latrobe.edu.au

General

Some students may wish to select from units offered across several streams.

Such programs will need to be negotiated with the course coordinator. It is also possible to select up to two units from another university in the Consortium.

PART II UNITS

Subject Code	Subject Name	Semester	Mode
PHE5ALP	Action Learning Project	1 & 2	O
PHE5AHP	Advanced Health Promoting Palliative Care	1	D
PHE5ARS	Advanced Research Skills	1	O
PHE5AHR	Australia's International Health Relations	5	I/O
PHE5SDS	Community Based Health Service Delivery Systems	1 & 2	D
PHE5CHS	Comparative And Historical Study Of Health Systems	2	D
OCT4OHB	Ergonomics In OHS	1	D
PHE4EMD	Employment And Disability	5	I/D
PHE5EBP	Evidence Based Public Health: Knowledge, Skills And Practice**	1	I
MPH2049	Field Methods for IH Planning and Evaluation	1 & 2	I/O
GER4FSG	Foundation Studies In Gerontology	1 & 2	D
POL5GAG	Globalisation And Governance	2	O/D
PHE5HCQ	Health Care Quality	2	O
PHE5HEF	Health Economics And Finance	2	D
PHE5HIS	Health Information Systems	1	O
PHE5HSO	Health Management Strategy And Operations	2	O
PHE5HPA	Health Policy Analysis	2	I
PHE5AHP	Health Promoting Palliative Care	1	D
PHE5LAE	Health Service Law And Ethics	1	I/O
PHE5HSR	Health Service Resource Management	2	O / D
PHE5HOR	Healthy Organisations	1 & 2	D / O
PHE5HRM	Human Resource Management In Health Services	1	O
PHE5IPO	International Health Policy	2	I
PHE5IHE	International Perspectives On Health Economics	1	I
PHE5IHP	Introduction To Health Promotion	1 & 2	I / D
OCT4OHA	Occupational Health And Safety Principals And Legislation	1	D
GER5PPA	Policy, Planning and Practice in Aged Care	1 & 2	D
MPH2048	Primary Health Care In Developing Countries **	1 & 2	I / O
PHE5PDE	Program Development And Evaluation	2	O
PHE5PHG	Promoting Health Through Groups	1 & 2	D / O
PHE5DDG	Public Health Approaches To Death, Dying And Grief	2	D
PHE5PHL	Public Health Law	2	I
PHE5PHP	Public Health Promotion	1 & 2	D / O
PHE5QMH	Qualitative Methods In Health Research	2	O
PHE5QRH	Quality Review Of Health And Community Support Services	1	O
PHE5QRM	Quantitative Research Methods In Health	2	O
PHE5REC	Rehabilitation Counselling	2	O
PHE4RRD	Rehabilitation Research Design	1 & 2	O
OCT4OHC	Screening And Monitoring In OHS	2	D
POL5SPW	Security Policy In A Borderless World	1	O

** (Monash University/Burnett Centre)

PART II UNITS

Subject Code	Subject Name	Semester	Mode
PHE5SCC	Service Coordination And Case Management	1	D
PHE5DDG	Sociology Of Death, Dying And Grief	2	D
PHE5SHI	Sociology Of Health And Illness	1	O
PHE5SFN	Sociology Of Food & Nutrition	2	I/O
PHE5SPC	Spiritual Palliative Care	2	D
PHE5AHS	The Australian Health Care System	1	D
PHE5SUP	The Service User Perspective In Health Care	1 & 2	D
PHE5VOR	Vocational Rehabilitation	1	D

For further details regarding units offered
by La Trobe University refer to:
http://www.latrobe.edu.au/publichealth/Units/unit_index_4and5.htm

D Distributed Learning / Distance Education
I Intensive / Block
O On campus

ENTRY REQUIREMENTS AND APPLICATIONS

Local Student Entry Requirements

Application requirements vary between Consortium institutions.

For further details and an application form please contact your chosen university using the details listed on Section 7.

Selection into the program will be based on a consideration of qualifications, experience in public health, professional involvement, and a personal statement outlining the reasons for applying. Students may be entitled to credit of up to eight units depending upon their original training, work experience and previous coursework completions.

International student requirements

Application requirements for international students vary between the four universities in the Consortium. As well as fulfilling the general requirements above, students need to meet the specific entry requirements of the university they apply to.

International students applying to La Trobe University must have a minimum of two years work experience in an appropriate field prior to commencing their MPH course. Please see the University website for details of the English language requirements. www.latrobe.edu.au/international/apply/english.html

For full details and an application form please contact your chosen university using the details listed.

The International Office

La Trobe University
Victoria 3086 Australia
Telephone: 61 3 9479 1199
Fax: 61 3 9479 3660

Web: www.latrobe.edu.au/international/

5.3» Monash University

OVERVIEW

Course requirement: 12 units

Length: Full time (18 months) Part time (3 years)

Unit delivery: On campus / off campus / intensive block units / on-line

The Monash University specialist streams are:

- Clinical Research Methods
- Health Services Management
- Health Economics
- International Health
- Occupational and Environmental Health
- Research Stream
- General Stream

This course is comprised of 12 units:

2 Part One core units:

Epidemiology and Demography
Introductory Statistics and 10 Part Two units.

Part Two is comprised of one core unit plus nine units from the various health specialisation stream coursework or research options.

The options are:

- nine units(coursework)
(including up to three MPH Consortium units)
- seven units (including up to three MPH Consortium units)
plus a minor research project (equivalent to two units)
- five units (including up to three MPH Consortium units) plus
a major research project (research) (equivalent to four units)

COURSE DETAILS

The Department of Epidemiology and Preventive Medicine at Monash University is at the forefront of postgraduate teaching in public health, clinical epidemiology, health risk assessment management, health services management, international health, biostatistics, occupational and environmental health and research. As well as being a centre of excellence dedicated to learning, the Department also has a substantial collaborative research program in clinical and public health research.

Our strong teaching base can make your study experience exciting and rewarding. Our graduates obtain employment in a wide diversity of fields within the health sector, including professional practice, research, public health sector, management positions within health care facilities, international positions with aid organisations or in developing countries.

The Monash MPH provides you with the full range of quantitative, analytical and communication skills necessary to work in the broad

domain of public health. This degree provides you with skills in the quantitative methods of the population-based health sciences and their problem solving application for health care provision within Australia and developing countries. Health specialisation streams are offered in clinical epidemiology, environmental health, health economics, health services management, international health, occupational health and research. This course can lead to the Doctor of Public Health.

SPECIALIST STREAMS

Clinical Research Methods

The Clinical Epidemiology stream assists you to make rational evidence-based decisions in clinical practice. Clinical epidemiology attempts to answer clinical questions relevant to the daily practice of medicine and other health sciences, and to improve patient care. It focuses on individuals or groups of patients in clinical settings.

Core units

- Research methods
- Clinical trials
- Clinical Measurement
- Ethics, good research practice and practical research skills
- Meta analysis and systematic reviews
- Data Management & Computing

Elective units (select six)

A. Recommended elective units

- Regression Methods for Epidemiology
- Clinical Epidemiology
- Chronic Diseases: Epidemiology and Prevention
- Infectious diseases: Epidemiology and Prevention

B. Other Electives

- Other DEPM units
- Selected from MPH postgraduate units

- Injury Epidemiology and Prevention
- Prevention: Policies and Strategies
- Advanced Statistical Methods for Clinical Research
- Case Study/Practical Experience
- Minor Project (8000 – 10000 words)

MPH Consortium units (up to three)

- Environmental Influences on Health
- Health Promotion OR Communications and Training
- Public Health Policy OR Health Systems Policy
- Principles and Practice of Public Health
- Social and Cultural Perspectives in Public Health
- Health Economics and Program Evaluation

Coordinator: Professor Michael Abramson

Telephone: (03) 9903 0573

Email: michael.abramson@med.monash.edu.au

Health Economics

The Health Economics stream is designed for you to gain advanced skills in economics evaluation of public health programs and policy development. This is coordinated by the Monash Centre for Health Economics.

Core units

- Research Methods
- Introduction to Health Economics
- Economic Evaluation in Health Care
- Applied Health Economics and Health Policy

Elective units (select six from)

A. Recommended elective units

- Introduction to Microeconomics Theory and Practice
- Pharmaceutical Companies
- Principles of Health Economics for Developing Countries
- Financial Issues in Health Care Management

B. Other electives

- Other DEPM units
- Selected from MPH postgraduate units
- MPH Consortium units (up to three)
- Environmental Influences on Health
- Health Promotion OR Communications and Training
- Principles and Practice of Public Health
- Social and Cultural Perspectives in Public Health
- Health Economics and Program Evaluation

Coordinator: Ms Jenny Watts

Telephone: (03) 9905 0776

Email: jenny.watts@buseco.monash.edu.au

Health Services Management

The Health Services Management stream provides you with the skills necessary to manage clinical healthcare systems with attention to human resource, financial, information, medico-legal, political, cultural, economic, ethical, industrial, technological and psychosocial issues.

Core units

- Clinical Leadership and Management
- Principles of Health Care Quality Improvement
- Research Methods

Elective units (select seven from)

A. Recommended elective units

- Law for Health Systems
- Financial Issues in Health Care Management
- Health Systems Policy
- Reform and Development of Health Services

B. Other electives

- Other DEPM units
- Selected from MPH postgraduate units
- Case Study/Practical Experience

MPH Consortium units (up to three)

- Environmental Influences on Health
- Health Promotion OR Communications and Training
- Principles and Practice of Public Health
- Social and Cultural Perspectives in Public Health
- Introduction to Health Economics
OR Health Economics and Program Evaluation

Coordinator: Professor Just Staelwinder

Telephone: (03) 9903 0559

Email: just.staelwinder@med.monash.edu.au

International Health

The International Health stream provides you with the skills necessary to design, implement, and evaluate the relevant programs that address the major public health priorities of communities in developing countries. This is offered in combination with the Centre for International Health at the Burnet Institute.

Core units

- Primary Health Care in Developing Countries
- Field Methods for International Health Planning and Evaluation

Elective units (select eight from)**A. Recommended elective units**

- Health of Women and Children in Developing Countries
- Communicable Disease Control in Developing Countries
- Public Health in Refugee Settings
- Nutritional Issues in Developing Countries
- Health Ethics and Human Rights
- Aboriginal Health

- Managing Community-based HIV Programs in Developing Countries
- Health Communications and Training

B. Other electives

- Other DEPM units
- Selected from MPH postgraduate units
- Case Study/Practical Experience
- Minor project (8000 – 10000 words)

MPH Consortium units (up to three)

- Environmental Influences on Health
- Public Health Policy OR Health Systems Policy
- Principles and Practice of Public Health
- Social and Cultural Perspectives in Public Health
- Health Economics and Program Evaluation

Coordinator: Associate Professor Mike Toole

Telephone: (03) 9282 2167

Email: mbrown@burnet.edu.au

Occupational and Environmental Health

The Occupational Health stream assists you to prevent and manage health problems resulting from the workplace environment. It provides you with the skills necessary to evaluate health problems in communities thought to be associated with industrial activities.

Core units

- Introduction to Occupational Health and Safety
- Research Methods

Elective units (select three)

- Assessment and Control of Workplace Hazards

A. Recommended elective units

- Chemical and Biological Hazards
- Ergonomics and Physical Hazards
- Injury Epidemiology and Prevention
- Psychosocial Work Environment
- Environmental Health Risk Assessment and Management
- Safety Management Systems
- Critical appraisal of Occupational Health and Safety Information

B. Other electives

- Other DEPM units
- Selected from MPH postgraduate units
- Case Study/Practical Experience
- Minor Project (8000 – 10000 words)
- MPH Consortium units (up to three)
- Environmental Influences on Health
- Health Promotion OR Communications and Training
- Principles and Practice of Public Health
- Social and Cultural Perspectives in Public Health
- Health Economics and Program Evaluation

Coordinator: Professor Malcolm Sim

Telephone: (03) 9903 0582

Email: malcolm.sim@med.monash.edu.au

General Stream

The General stream allows you the flexibility to choose any combination of units to form a unique specialisation.

Core Unit

- Research Methods

Elective units (select nine from)**A. Recommended elective units**

- Prevention: Policies and Strategies
- Selected from DEPM MPH postgraduate units

B. Other electives – MPH Consortium units (up to three)

- Environmental Influences on Health
- Public Health Policy OR Health Systems Policy
- Principles and Practice of Public Health
- Social and Cultural Perspectives in Public Health
- Health Economics and Program Evaluation

Coordinator: Professor Flavia Cicuttini

Telephone: (03) 9903 0553

Email: flavia.cicuttini@med.monash.edu.au

Research

The Research stream gives you training in the methods used to undertake sound clinical or public health research as well as the practical skills in designing, undertaking and analysing a research project. Consultation with the Course Coordinator is required prior to enrolment into the research stream.

Prerequisite

Distinction (70%) average in the Epidemiology & Demography and Introductory Statistics units. Consultation with the course coordinator is required prior to enrolment into the research stream. Recommended: Distinction (70 per cent) average in the units Research Methods or Field Methods.

Core unit – major research

- Research Methods. Major project in one of the above MPH streams (12,000 – 15,000 words).

Elective unit – (select five from):**A. Recommended elective units**

- Selected from the DEPM MPH postgraduate units

B. Other electives – MPH Consortium units (up to three)

- Environmental Influences on Health
- Health Promotion OR Communications and Training
- Public Health Policy OR Health Systems Policy
- Principles and Practice of Public Health
- Social and Cultural Perspectives in Public Health
- Health Economics and Program Evaluation

Coordinator: Dr Belinda Gabbe

Telephone: (03) 9903 0951

Email: belinda.gabbe@med.monash.edu.au

Professional Recognition

This degree is recognised as a public health qualification in a number of professional fields. It fulfils the academic coursework requirements of the Australasian Faculty of Occupational Medicine.

PART II UNITS

Please check timetable on www.med.monash.edu.au/epidemiology/pgrad and or 2010 PG Course Guide for a full list of units, semester offered and mode of study

ENTRY REQUIREMENTS AND APPLICATIONS**Local Student Entry Requirements**

Application requirements vary between Consortium institutions.

For further details and an application form please contact your chosen university using the details listed on Section 7.

Applicants with an undergraduate degree in a relevant discipline and professional experience in a health related field are encouraged to apply. Those who do not have an undergraduate degree but have extensive relevant experience are welcome to apply. The selection process takes into account academic qualifications, experience, professional involvement and the personal statement.

International student requirements

Application requirements for international students vary between the four universities in the Consortium. As well as fulfilling the general requirements above, students need to meet the specific entry requirements of the university they apply to. For full details and an application form please contact your chosen university using the details listed.

Mail

Monash University International Centre
PO Box 73 Clayton, Victoria 3800 Australia

Visit

Monash University International Centre
Building 73 Wellington Road
Clayton Victoria 3800 Australia

Web: <http://monash.edu/study/international/>

5.4» The University of Melbourne

OVERVIEW

Course requirements:

200 Point Program

- a non-health related degree (or equivalent) and a minimum of two years' work experience in a health related field OR
- a health related degree (or equivalent) with no health related experience.

175 Point Program (25 Credit Points Advanced Standing)

- A health-related degree (or equivalent) and a minimum of two years' health-related work experience

150 Point Program (50 Credit Points Advanced Standing)

- Applicants with both, a health-degree (or equivalent) and a minimum of two years' public health relevant work experience.

Structure:

200 Point Program: 14 coursework subjects and a Research project

175 Point Program: 12 coursework subjects and a Research project

150 Point Program: 10 coursework subjects and a Research project

Length: Full time (1.5 to 2 years)/Part time (3 to 4 years)

Unit delivery: On campus / Distance education / intensive
Students are required to complete 12 to 16 units, depending on their entry pathway, including a 2-unit equivalent research project. Students need to complete at least four Part I Consortium units including Epidemiology & Demography and Introduction to Biostatistics.

The University of Melbourne specialist streams are:

- Epidemiology and Biostatistics
- Health Economics/Economic Evaluation
- Health Program Evaluation
- International Health
- Sexual Health
- Social Health
- Women's Health
- or a combination (by negotiation)

Website: <http://www.sph.unimelb.edu.au>

Email: sph-gradinfo@unimelb.edu.au

COURSE DETAILS

The School of Population Health at The University of Melbourne offers a unique and exciting range of postgraduate professional education and research training opportunities. The School is distinctive in Australia in joining social sciences and medical humanities with epidemiology, biostatistics and biomedical sciences to focus on a population health approach to clinical medicine, genetics and molecular biology, mental health, social health, indigenous health, international health and health care services, as well as traditional public health areas of communicable and chronic diseases. We see this approach as providing a translational bridge between new technology developments in genomics and proteomics through health services and social structures to the population whose health we aim to protect and promote.

The Research Project is one of the strengths of the Melbourne MPH, providing students with a chance to work one-on-one with a supervisor in a preferred skill area and/or within a health or disease context of interest. The project provides students the opportunity to consolidate and apply the knowledge and skills acquired through the coursework program, and creates opportunities for students to acquire applied experience in public health workplaces, build networks, and to publish in peer reviewed journals.

Students must complete a minimum of 4 Part I Consortium units (which must include Introduction to Biostatistics and Epidemiology & Demography), plus a minimum of four Part II units offered through the School of Population Health and the 2-unit research report. The full range of elective options is listed in the SPH handbook. Students may take up to 2 approved subjects offered outside the School of Population Health.

Course Coordinator
To Be Advised

SPECIALIST STREAMS

The University of Melbourne MPH is flexible and does not have fixed streams. The specialisations described below are available for those wishing to develop specific strengths in certain skill sets and/or health contexts. Lists of recommended subject choices and research projects are available in the School of Population Health Handbook (available online at <http://www.sph.unimelb.edu.au/postgrad/>). Students can tailor subject choices to suit their interests provided they meet course requirements and have course coordinator approval. Students can obtain assistance in putting together their own inter-disciplinary course plan from the course coordinator during organised enrolment sessions at the beginning of each year, or by appointment throughout the year.

Economic Evaluation

Students specialising in Economic Evaluation will learn to appreciate when an economic evaluation might be needed, the types of economic appraisal that are available, together with their strengths and limitations. Students will appreciate how "economic evaluation" differs from other forms of evaluation; the steps involved in conducting an economic evaluation; and the key issues of protocol design.

Through practical case studies students will be able to distinguish a "good" study from a "poor" study", and understand the various factors which may impact on how economic evaluation is received by managers, together with other possible stakeholders. Students will be introduced to the links between economic evaluation and priority setting/health service planning.

Research Projects in Economic Evaluation have considered such topics as:

- Allocative efficiency in health promotion program planning: A protocol using Program Budgeting and Marginal Analysis (PBMA)
- Assessing Cost Effectiveness (ACE) in Mental Health: Psychological and pharmacological interventions for generalised anxiety disorder;
- Cost-effectiveness of vaccines: Methodological issues

Stream Coordinator: Dr Arthur Hsueh

Telephone: (03) 8344 0649

Email: ahsueh@unimelb.edu.au

Epidemiology and Biostatistics

This specialisation focuses on the core epidemiologic and analytic knowledge and skills that underpin health research and applied epidemiology. Students who specialise in Epidemiology and Biostatistics develop a broad understanding of the value and basic principles of epidemiological methods in public health, evidence-based practice and medical research, including its biostatistical underpinnings.

Students develop skills in; study design and appraisal, data management and statistical analyses for handling a variety of practical problems; and the technical skills to practice in applied epidemiology in the public health setting and/or progress to further postgraduate studies in epidemiology and/or biostatistics. Students also have the opportunity to augment basic epidemiology skills with specialist knowledge and techniques in key areas – genetic, molecular and infectious disease epidemiology.

Students use the research project as an opportunity to gain further applied experience in epidemiologic and analytic methods, develop higher level skills in specific methods, build networks with

practitioners in their area of interest, and to apply their knowledge and skills to a particular research area, disease group, and/or population of interest.

Stream Coordinators:

Professor Dallas English

Telephone: (03) 8344 0742

Email: d.english@unimelb.edu.au

Dr Mark Jenkins

Telephone: (03) 8344 0902

Email: m.jenkins@unimelb.edu.au

Health Economics

Students specialising in Health Economics will learn to appreciate and apply the key concepts behind health economics as a way of thinking.

They will be able to analyse and discuss key policy issues in public health from an 'economic' perspective. They will, for example, critically appraise the structure and financing of the Australian health care system, understand and assess health expenditure trends and their associated policy implications. They will consider the arguments for and against competition in health care (and 'economic rationalism'), and apply economic reasoning to policy problems (such as the strengths and weaknesses of reform options for Medicare). Students often choose to combine Health Economics with Economic Evaluation (see below) and Health Policy subjects.

Research projects in Health Economics have considered topics such as:

- Managed Care in Indonesia: Assessment of health insurance approaches
- The appropriate use of financial levers to promote preventative care by GPs.

Stream Coordinator:

Dr Arthur Hsueh

Telephone: (03) 8344 0649

Email: ahsueh@unimelb.edu.au

Health Program Evaluation

Students specialising in Health Program Evaluation acquire knowledge and skills in both the theory and applied practice of the evaluation of health programs and interventions. There is a strong emphasis on broadening the roles of program evaluation to include program planning, design, implementation, or monitoring as the evaluative focus, well as the more traditional impact evaluation. The importance of negotiation and planning of program evaluations with commissioners and stakeholders to enhance knowledge utilisation is stressed, and students develop skills in defining appropriate evaluation questions; applying a variety of data collection and analysis strategies; the effective reporting of evaluations; and developing different evaluation plans for pro-active, clarificative, interactive, monitoring and impact evaluation purposes. The role of program evaluation in the conduct of public health programs and its role in the support in health care management through capacity building is examined.

Students may choose to combine their study of Health Program Evaluation with the study of Economic Evaluation, as both represent important approaches to health services research and evaluation. There is now a wide choice of subjects focusing upon Health Program Evaluation and the closely associated Health Services Research as well.

Recent research projects by students completing the health program evaluation stream have included:

- Evaluations of the "Challenging Ageing" Program in Victoria, and a clinical pathway to improve peri-operative care in patients with diabetes
- An evaluation plan for a program designed to provide orthopedic interventions for children in Nepal
- A needs assessment plan for an adolescent dental care program in Indonesia
- An investigation into the extent to which evaluation is incorporated into quality improvement programs in selected hospitals in Victoria

Both local and international graduates with a health program evaluation specialisation work in organisations in a variety of roles, including the commissioning and management of evaluations; practical program evaluation within the organisation; program and intervention development, delivery and evaluation; policy analysis; and all are involved in program evaluation utilisation. Many work where their specialisation is their key role, while most have program evaluation as an important role in their work.

Stream Coordinator: Ms Rosemary McKenzie
Telephone: (03) 8344 0710
Email: rmckenzie@unimelb.edu.au

International Health / Harm Reduction

The international health specialisation places particular emphasis on health in resource poor settings. Students will gain skills in needs assessment, in program planning, implementation and evaluation and application of these in international health settings. Based on a research project in international health, students will gain an understanding of the global issues which impact on the health of income poor populations.

There may be opportunities to do this research in an international setting. This specialisation is suitable for people who are currently working in international health, students from income poor countries and those interested in gaining qualifications that will enable them to develop and implement best practice responses to global health issues. It will assist people planning for employment with international aid/development agencies and NGOs.

Stream Coordinator: Dr Alison Morgan
Telephone: (03) 8344 1634
Email: apmorgan@unimelb.edu.au

Sexual Health

The Sexual Health stream in the MPH focuses on the important recognition and understanding of how sexual health impacts on the public health of communities. In developed countries recent changes in the epidemiology of many STIs and changing sexual behaviour patterns have focused attention deservedly on improving access to services and the protection and empowerment of those most vulnerable in society. In addition many other social, cultural and economic influences are acknowledged as important considerations in the study and practice of sexual health.

This sexual health specialisation enables students to familiarise themselves with the important public health implications of sexual health and to develop an advanced knowledge of the literature in a related area of interest. Students may have a clinical or non-clinical interest and professional background. Whilst sexual health priorities may differ between resource poor and resource rich settings, many of the public health implications overlap and both local and international students will be able to find a relevant area of interest within sexual

health to study. Students with a specialised sexual health qualification in public health will find this relevant to work in a wide variety of areas including clinical sexual health services, policy and government related areas and international health.

Stream Coordinator: Dr Henrietta Williams
Telephone: (03) 9341 6249
Email: hwilliams@mshc.org.au

Social Health

The Social Health specialisation uses the social sciences as its base; it uses a multidisciplinary approach that integrates a variety of humanities and social sciences perspectives on health and health care. It incorporates subjects from health ethics, sociology of health and illness, medical anthropology and the history of health care.

The Social Health specialisation draws on national and international developments in health care knowledge and practice that urge us to address health in new ways. The Social Health specialisation provides higher order skills in social health with an emphasis on critical analysis, and written and verbal communication. The social and political dimensions of illness and suffering and the cultural differences in the understanding of health care delivery present important challenges, not only to practitioners, but also to administrators and planners.

For example, a social health approach provides the opportunity to address such areas as: social determinants of health, complex ethical health issues arising out of the use of stem cell research, and the development of culturally sensitive population health programs.

Stream Coordinator: To Be Advised

Women's Health

The Women's Health specialisation is skills-based and emphasises new knowledge and competence in clinical fields and public health. It provides professional education for graduates who work or intend to work as researchers, clinicians, policy makers or educators in the expanding field of women's health, or who are interested in the ways in which gender affects health risks, status and outcomes.

Students undertaking study in this area have the opportunity to gain a sophisticated understanding of the various dimensions of effective women's health practice, including health promotion and the design and evaluation of gender sensitive health care policies and programs, and will develop an understanding of the multiple determinants of women's health.

Stream Coordinator: Dr Louise Keogh
Telephone: (03) 8344 40692
Email: l.keogh@unimelb.edu.au

PART II UNITS

Unit Code	Unit Name	Semester	Mode
505435	Aboriginal Health: Past to Present	1	O
505535	Aboriginal Health: Past to Present	1	O
505994	Behaviour Society and Health	2	O
505434	Clinical Sexual & Reproductive Health	1	B
505534	Clinical Sexual & Reproductive Health	1	B
505996	Community: Theory and Practice	2	I
505531	Control of Sexually Transm. Infections	1	O or D
505995	Critical debates in Population Health	2	O
505902	Disability in Developing Countries	2	I
505961	Drugs and society: A Global Perspective	2	I
505955	Drugs In Society	2	E
505907	Economic Evaluation 1	1	O
505909	Economic Evaluation 2	2	O
505112	Environmental Influences on Health	2	O
505102	Epidemiology	1	O
505969	Epidemiology & Analytic Methods I	1	I
505970	Epidemiology & Analytic Methods II	1	I
505974	Epidemiology in Practice	2	I
505997	Ethical Dimensions of Health Care	1	O
505958	Field Methods For Health Management	1 or 2	I
505991	Gender & Health	1	O
505926	Genetic Epidemiology	2	O or D
509001	Global Health Research and Practice	1	I
505960	Harm Reduction - Hiv In Drug Users	2	I
505989	Health and Public Policy	1	O
505100	Health Economics & Program Evaluation	2	O
505908	Health Economics I	1	O
505990	Health Ethics	1	O
505509	Health Program Evaluation 1	1	O or D
505904	Health Program Evaluation 2	2	O or D
505110	Health Promotion	2	O
505993	Health Systems	2	O
509002	HIV and AIDS: An evolving global response	1	O
505929	Infectious Disease Epidemiology	1	O
505901	International Adolescent Health	S	I
505900	International Child Health	2	I
505992	Key Concepts in Medical Anthropology	2	O
505971	Linear & Logistic Regression	2	O
505439	Living Longer: Global Perspectives	1	O

Unit Code	Unit Name	Semester	Mode
505539	Living Longer: Global Perspectives	1	O
505957	Primary Health Care In Developing World	1 or 2	I
505963	Primary Health Care, Jamkhed, India	2/S	E
505111	Principles & Practice of Public Health	1	O
505998	Principles of Social Research Design	S	O
509003	Public Health Leadership	2	I
505113	Public Health Policy	1	O
509004	Sex Work, Drugs & HIV: A Global outlook	1	B
505433	Sexual and Reproductive Health	1	O or D
505533	Sexual and Reproductive Health	1	O or D
505432	Sexually Transmissible Infections	2	O or D
505532	Sexually Transmissible Infections	2	O or D
505109	Social & Cultural Perspec in Public Hlth	2	O
505986	Social Analysis in Health 1	2	O
505987	Social Analysis in Health 2	2	O
505988	Social Determinants of Health	1	O
505999	Social Sciences Research Methods	1	O
505101	Statistics	1	O
505973	Study Design in Epidemiology	1	I
505972	Survival Analysis & Regression for Rates	2	O
505525	Women and Global Health	2	I

D Distance Education E Off Campus O On Campus I Intensive/Block

For further details regarding units from the University of Melbourne refer to: www.sph.unimelb.edu.au

Disclaimer

The University may suspend or change the details of any subject. Subjects may be suspended if enrolments are low or if teaching staff become unavailable. If a subject in which you are enrolled is cancelled you will be notified via your University email address and asked to remove the subject from your enrolment and find a suitable replacement.

ENTRY REQUIREMENTS AND APPLICATIONS

Application requirements vary between Consortium institutions. For further details and an application form please contact your chosen university using the details listed on Section 7.

Entry to the MPH at The University of Melbourne is open to local and international graduates with a good pass degree in a health related discipline or to holders of diplomas or professional certificates with relevant work experience. Entry is also open by transfer to students currently undertaking the Australian Government Health and Ageing Postgraduate Studies Program. Advanced standing may be granted to applicants who in addition to their health-related degree have completed a minimum of 2 years work experience in a related field

International applicants are required to meet the University's English Language Requirements. Please visit <http://www.futurestudents.unimelb.edu.au/courses/pgenglishreq> for more information on this requirement.

International Centre

The University of Melbourne
Victoria 3010 Australia

Telephone: 61 3 8344 4505

Fax: 61 3 9347 9062

Web: <http://www.futurestudents.unimelb.edu.au/int/index.html>

6» International Students

OVERVIEW

The Victorian Consortium for Public Health welcomes international students.

The Victorian Consortium for Public Health welcomes international students. By studying with the Consortium, international students have the opportunity to extend their Melbourne social networks beyond students at their home university. For the first year of study, international (and local) students from Deakin University, La Trobe University, Monash University and The University of Melbourne, take classes together, at the Parkville campus of The University of Melbourne. This campus is close to the city and public transport.

After completion of these subjects, usually in the first or second year of study, students study at their home university.

Orientation for international for international students generally commences a week prior to the start of semester. During orientation,

international students attend informal study sessions to help acquaint them with the Australian health system. They also find out about student support systems, visit some Melbourne public health institutions and see some local tourist attractions. Orientation is a good time to make new friends, become familiar with the Parkville campus, test out Melbourne's public transport system and ease into new studies.

Additional tutorials in the Part I Consortium units run at Parkville throughout each semester. These are informal and allow students to go over any material they are having problems with lectures.

7» Contact Details

MASTER OF PUBLIC HEALTH ADMINISTRATORS

Deakin University

Ms Marianne Langa
School of Health and Social Development
Deakin University
Burwood Campus
221 Burwood Highway
Burwood, Victoria 3125
Phone: (03) 9244 6905
Email: marianne.langa@deakin.edu.au

Monash University

Postgraduate Office
Dept of Epidemiology and Preventive Medicine
Monash Medical School,
Alfred Hospital
Melbourne, Victoria 3004
Phone: (03) 9903 0563
Email: pgradenq@med.monash.edu.au

La Trobe University

School of Public Health
La Trobe University
Victoria 3086
Phone: (03) 9479 1750
Email: phe.postgrad@latrobe.edu.au

The University of Melbourne

Academic Programs Office
School of Population Health
The University of Melbourne
Victoria 3010
Phone: (03) 8344 9339
Email: sph-gradinfo@unimelb.edu.au

VCPH Administrator

Postgraduate Office
Dept of Epidemiology and Preventive Medicine
Monash Medical School, Alfred Hospital
Melbourne, Victoria 3004
Phone: (03) 9903 0563
Email: pgradenq@med.monash.edu.au

MASTER OF PUBLIC HEALTH COURSE COORDINATORS

Deakin University

Dr Emma Miller
School of Health and Social Development
Phone: (03) 9244 6136
Email: emma.miller@deakin.edu.au

La Trobe University

Dr Priscilla Robinson
School of Public Health
Phone: (03) 9479 5595 or (03) 9285 5269
Email: priscilla.robinson@latrobe.edu.au

Monash University

Professor Flavia Cicuttini
Dept of Epidemiology and Preventive Medicine
Phone: (03) 9903 0158
Email: flavia.cicuttini@med.monash.edu.au

The University of Melbourne

To Be Advised

University of Melbourne CRICOS Provider Code: 00116K
Monash University CRICOS Provider Code: 021280B
Deakin University CRICOS Provider Code: 020018B
La Trobe University CRICOS Provider Code (Bundoora, Albury/
Wodonga campuses): 00115M

8» Notes

8» Notes

8» Notes

